

WASCOMAT TD30, TD50 & TD75 DRYERS

Gas and Energy Efficient • Save Labor • Durable • Reliable

REDUCES GAS CONSUMPTION

Efficient drying cycle flexibility, automatic temperature control, long machine life and energy savings...

Ideal for: hotels, motels, hospitals, nursing homes, clubs, commercial laundries, institutional laundries.



Model TD30
(30 lb. Capacity)

Model TD50
(50 lb. Capacity)

Model TD75
(75 lb. Capacity)

Easy to understand "How to use" pictograms on control panel

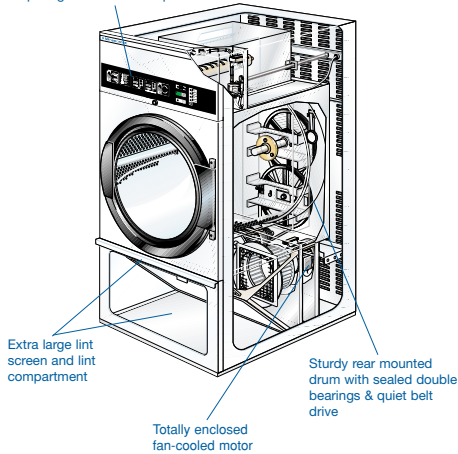

TD50 and TD75 dryer models provide a more efficient laundry flow. TD dryer models provide a high drying capability, low operating costs and outstanding features whatever heating source is used: gas, steam or electric.

TD30 features an extra slim design, approximately 28" wide, saving valuable space for more drying capacity. It's **ideal for replacement of old, energy wasting, wide dryers to increase drying capacity.**

User friendly, easy to install, operate and service

- Easy to understand drying instruction pictograms, regardless of operators' language
- Easy to load door opens to 180° wide
- Large, self-cleaning lint filter
- Built-in diagnostic service program
- Easy service access

Environmentally friendly

- Certified according to ISO 9001 and ISO 14001
- Noise levels below 70 dbA for quiet working environment

Optional Drum Reversing Action

- Reduces tangling and wrinkling for improved finish quality

High quality inside and out

- Rear-mounted drum bearing trunion with sealed double bearings
- Totally enclosed motor
- Interior parts of galvanized steel to prevent corrosion
- Attractive and durable powder painted panels
- Riveted cabinet for extra strength to prevent weld cracking and rust
- The heat shuts off if the airflow is blocked
- Fully enclosed cabinet – no access to any moving part
- Finger protection in lint screen compartment
- Dryer stops when door is opened

Unique Residual Moisture Control (RMC) option

Features and Benefits

Other dryers measure only outgoing air temperature as moisture control, which is not accurate. Only Wascomat's true Residual Moisture Control provides the proper measure of the true moisture content in the garment for:

- Shortest possible drying time
- No over-drying
- Dryer stops when the clothes reach the desired dryness
- Less operator surveillance
- Less garment wear
- Less energy used
- Better laundry economy

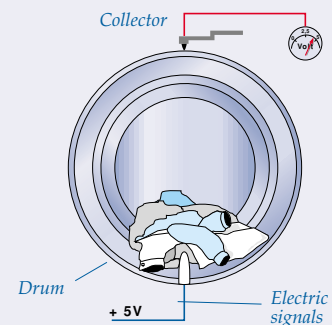

A low voltage current is passed through the laundry by specially insulated lifters. The moisture is measured 400 times per second with a sensor and collector assembly. The RMC microprocessor maximizes the desired drying process.

Technical Specifications

Model	TD30		TD50		TD75	
Capacity (lb/kg)	30	13.5	50	23	75	34
Width - A (in/mm)	27 15/16	710	37 13/16	960	37 13/16	960
Depth - B (in/mm)	44 1/8	1120	46 7/16	1180	53 15/16	1370
Height - C (in/mm)	74	1880	78 9/16	1995	78 9/16	1995
Depth with door open - D (in/mm)	71 1/4	1810	83 7/16	2120	90 9/16	2300
Bottom of door - E (in/mm)	28 9/16	725	25 9/16	650	25 9/16	650
Door opening diameter (in/mm)	22 13/16	580	31 7/8	810	31 7/8	810
Cylinder volume (ft ³ /l)	10.1	286	18.6	528	23.0	650
Cylinder diameter (in/mm)	26 3/4	680	35 15/16	913	35 15/16	913
Cylinder depth (in/mm)	31 1/8	790	31 15/16	812	39 5/16	998
Noise level (dBA)	<70		<70		<70	
Net wt (lb/kg) (gas heat)	485	220	732	332	761	345
Crated weight (lb/kg)	547	248	765	347	807	366

Utility Connections						
Exhaust duct diameter (in/mm)	8	200	8	200	8	200
Gas connection	1/2 NPT		1/2 NPT		3/4 NPT	
Steam: inlet & condensate	1/2 NPT		3/4 NPT		3/4 NPT	
Exhaust - G	6 11/16	170	8 7/8	225	8 7/8	225
Exhaust - H	5 5/16	135	6 1/8	155	6 1/8	155
Electrical and gas connections - J	63 3/8	1610	67 15/16	1725	67 15/16	1725
Gas connection - K	9 13/16	250	10 5/8	270	10 5/8	270
Electrical and steam connections - L	54 5/16	1380	59 7/16	1510	59 7/16	1510
Electrical connection - M	9 13/16	250	10 5/8	270	10 5/8	270
Steam connections - N	18 1/2	470	23 7/16	595	23 7/16	595

Energy Data						
Gas (BTU/h)	71,600		136,400		151,200	
Airflow (ft ³ /min / m ³ /h) (gas heat)	406	690	683	1160	647	1100
Electric (kW)	18 (13.5 optional)		30 (24 optional)		30 (36 optional for 440V)	
Airflow (ft ³ /min / m ³ /h) (elec heat)	406	690	624	1060	647	1100
Airflow (ft ³ /min / m ³ /h) (opt elec heat)	253	430	494	840	647	1100
Steam (kW at 90 psi)	27		46		46	
Airflow (ft ³ /min / m ³ /h) (steam heat)	544	925	812	1380	647	1100
Steam consumption (lb/h / kg/h @90psi)	119	54	190	86	190	86

Electrical Requirements						
Full-load Amps gas & steam: 120V/60	5.8		8.3		16.5	
gas & steam 208-240/60/1Ø	2.9		4.2		8.3	
gas & steam 208-240/60/3Ø	3.75		3.8		5	
elec 208-240/60/3Ø	45		80		80	
Circuit breaker (Amps): 120V/60	15		15		20	
208-240V 1Ø gas & steam	15		15		15	
3Ø gas & steam	15		15		15	
3Ø electric	65		100		100	
Motor output - 1Ø blower (hp/kW)	0.5 / 0.37		1.5 / 1.1		0.68 / 0.5	
Motor output - 1Ø drum (hp/kW)					1 / 0.75	
Motor output - 3Ø blower (hp/kW)	0.5 / 0.5		0.5 / 0.37		1 / 0.75	
Motor output - 3Ø drum (hp/kW)	0.5 / 0.5		0.5 / 0.37		0.5 / 0.37	

Alternate Voltages

Alternate voltages available. Contact Wascomat Sales Department for details.

Pressures						
Gas (inches H ₂ O/mbar): Natural	7-12	18-30	7-12	18-30	7-12	18-30
LP	11	30	11	30	11	30
Steam (psi/bar) (max)	102	7	102	7	102	7
Exhaust (inches H ₂ O/mbar) (max)	0.08	0.2	0.24	0.6	1.37	3.4

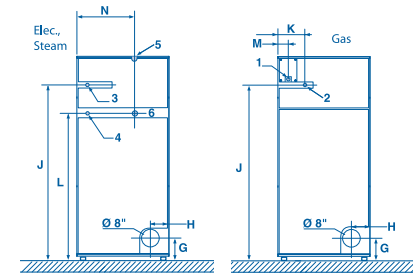
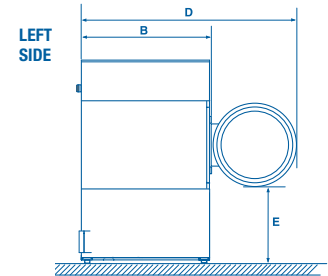
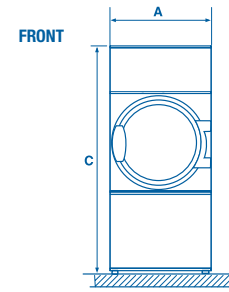

1. Electric entrance (gas heated)
2. Gas entrance
3. Electric entrance (EL heated)
4. Electric entrance (steam heated)
5. Steam entrance
6. Condensate outlet (steam heated)



Refer installation and servicing to qualified, licensed personnel. Always read installation and operating manuals and consult local codes before installation. Protect machines with properly rated, inverse-time, common-trip, industrial-type circuit breakers ONLY. Warranty void if not properly installed. Advise when placing order if dryers are for installation at altitudes in excess of 1000 feet above sea level, as this may require a gas-orifice change. Contact Wascomat for more information and availability of machines for electric services not listed. Specifications subject to change without notice. Wascomat assumes no responsibility for errors or omissions in this information.

For more information on the full line of Wascomat washers, dryers and low-cost financing, call Wascomat toll free today.

Wascomat Laundry Equipment

1-800-645-2204 • www.wascomat.com

461 Doughty Blvd., Inwood, L.I., N.Y. 11096-0338
 Sales and Administration – Tel: 516-371-4400 • Fax: 516-371-4204 • e-mail: sales@wascomat.com
 Spare Parts – Tel: 516-371-2000 • Fax: 516-371-4029 • e-mail: parts@wascomat.com
 Technical Support – Tel: 516-371-0700 • Fax: 516-371-4029
 En Mexico: Llame gratis a este numero 001-800-010-1010

Your local independent authorized dealer

